

# INSTALLATION INSTRUCTIONS

FOR ITEM 285609 (28.5" Wide Fleur-de-lis Semi-Flush Mount)

*Meyda*  
CUSTOM LIGHTING

**CAUTION: FAILURE TO INSTALL THIS FIXTURE PROPERLY MAY RESULT IN SERIOUS PERSONAL INJURY OR DEATH AND PROPERTY DAMAGE.** We recommend installation by a licensed electrician.

This product must be installed in accordance with applicable installation code(s), by a person familiar with the construction and operation of the product and the hazards involved.\*

**Caution:** Do not exceed maximum wattage noted on fixture. Use only recommended bulbs with fixture.

## FIXTURE COMPONENTS

1. HUB ASSEMBLY (MOUNTING PLATE W/ STUDS, HUB, HUB SHADE, VASE CAP, FINIAL)
2. ARM
3. CLUSTER ASSEMBLY
4. SHADE RING
5. SHADE

### **Caution:**

**Fixture is OVERWEIGHT and not suitable for installation with standard Junction Box.**

**Be sure power is off at the main breaker box prior to installation.**

**Read all instructions in their entirety before beginning installation.**

1. Carefully unpack all components and make certain that everything is on hand.
2. Remove Hex Nuts from the Hub Assembly to release the Mounting Plate W/ Studs, Save it for later.
3. Using Customer Supplied Hardware, affix the Mounting Plate W/ Studs directly to the ceiling ensuring the connection is suitable for 60 lbs. and that electrical supply wires remain accessible.
4. Following all Local Codes and procedures, make electrical wire connections from supply wires to fixture lead wires.
5. Lift Hub up to the Ceiling, allow studs to protrude through hub.
6. Secure the Hub using Hex Nuts from before.
7. Install 2X 15W E12 B10 Bulbs (not included) into the sockets.
8. Slide Hub Shade over the Threaded Rod.
9. Secure it in place using Vase Cap and Finial.
10. Install the Arms by the Hooks on the Hub Assembly.
11. Install the shade inside Shade Ring
12. Install the Cluster Assembly inside the shade, so that the studs protrude through the Crossbar.
13. Secure the Cluster using Hex Nuts.
14. Lift Up the Shade and Hang it to the other end of the Arms.

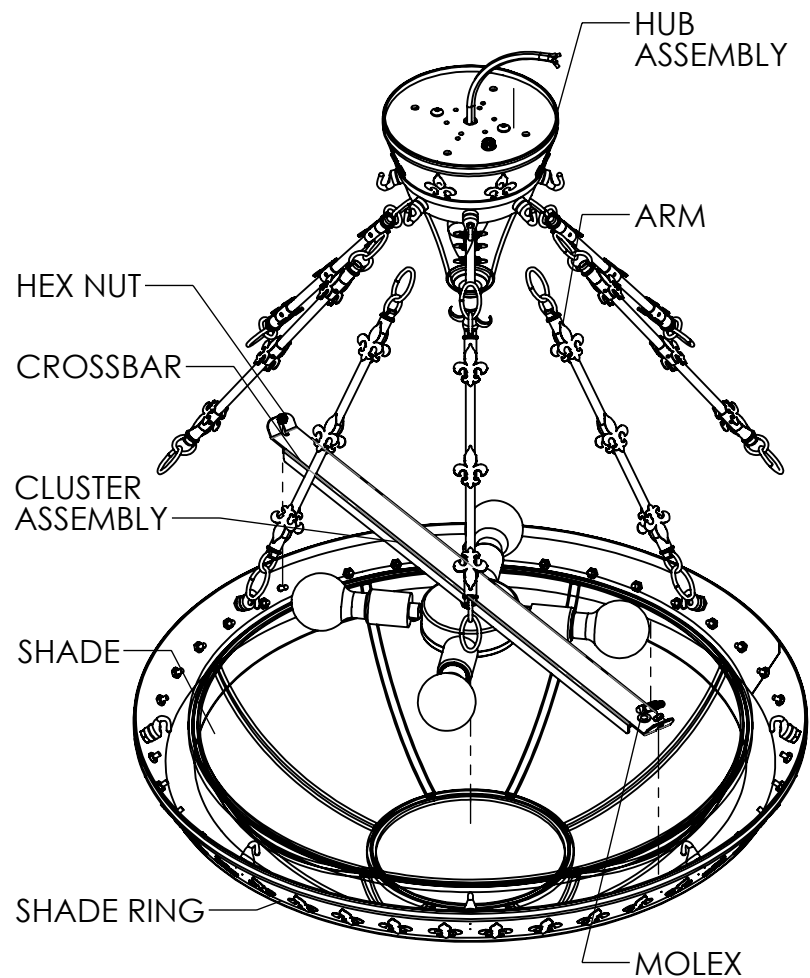

# INSTALLATION INSTRUCTIONS

FOR ITEM (28.5" Wide Fleur-de-lis Semi-Flush Mount)

*Meyda*  
CUSTOM LIGHTING

**CAUTION: FAILURE TO INSTALL THIS FIXTURE PROPERLY MAY RESULT IN SERIOUS PERSONAL INJURY OR DEATH AND PROPERTY DAMAGE.** We recommend installation by a licensed electrician.

This product must be installed in accordance with applicable installation code(s), by a person familiar with the construction and operation of the product and the hazards involved.\*

**Caution:** Do not exceed maximum wattage noted on fixture. Use only recommended bulbs with fixture.

15. Make sure that the Arm with the Molex Plug is closer to the Molex Plug on Crossbar.
16. Install 4X 60W E26 A19 Bulbs (not included) into the sockets.
17. Complete the connection by connecting the Molex Plug.
18. Power On and ENJOY!!!

HEX NUT (CROSSBAR)



QTY.- 2

HEX NUT (HUB ASSEMBLY)

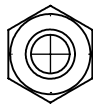

QTY.- 2

MOUNTING PLATE

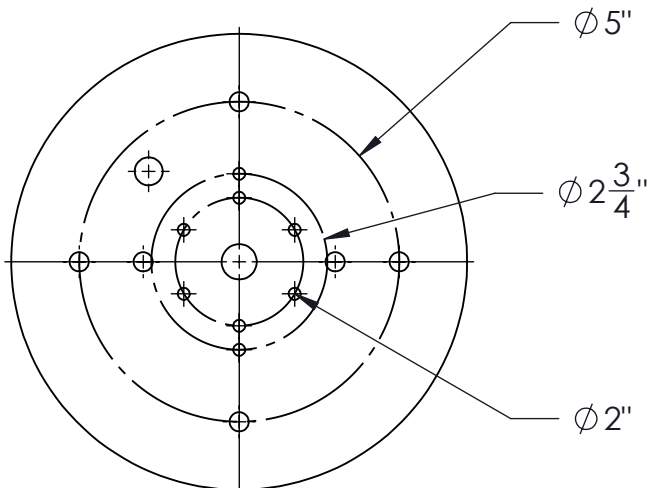

HUB ASSEMBLY

