

# INSTALLATION INSTRUCTIONS

FOR ITEM 284772

*Meyda*  
CUSTOM LIGHTING

**CAUTION: FAILURE TO INSTALL THIS FIXTURE PROPERLY MAY RESULT IN SERIOUS PERSONAL INJURY OR DEATH AND PROPERTY DAMAGE.** We recommend installation by a licensed electrician.

This product must be installed in accordance with applicable installation code(s), by a person familiar with the construction and operation of the product and the hazards involved.\*

**Caution:** Do not exceed maximum wattage noted on fixture. Use only recommended bulbs with fixture.

## FIXTURE COMPONENTS

1. MOUNTING PLATE WITH STUDS
2. CANOPY STEM
3. SMALLER FABRIC SHADE
4. LARGER FABRIC SHADE
5. ACRYLIC BOTTOM

### **Caution:**

***Be sure power is off at the main breaker box prior to installation.***

***Read all instructions in their entirety before beginning installation.***

1. Carefully unpack all components and make certain that everything is on hand.
2. Remove Mounting Plate from Canopy Stem by unscrewing Brass Balls on the bottom of the Canopy.
3. Using Customer Supplied Hardware affix the Mounting Plate directly to J-Box ensuring connection is suitable for a minimum of 35 lbs and that electrical supply wires remain accessible.
4. Unravel the wire at the top of the Canopy and lift the Canopy Stem up to the ceiling.
5. Following all local codes and procedures make electrical connections from supply wires to fixture lead wires.
6. Connect the Canopy back to the Mounting Plate using the Brass Balls from prior.
7. Lift the Smaller Fabric Shade up to the Crossbar on the Canopy Stem and secure using provided Acorn Nuts.
8. Lift the Larger Fabric Shade up and align with the Crossbar on the Canopy Stem, Secure the Larger Fabric Shade using provided screws and acorn nuts.
9. Install 3X E26 A19 Bulbs (not included) into Sockets.
10. Carefully lift the Acrylic Bottom up to Smaller shade and secure using a provided Round Check Ring on the inside and a Finial on the outside.
11. Power on and ENJOY!!!

### **OVERALL**

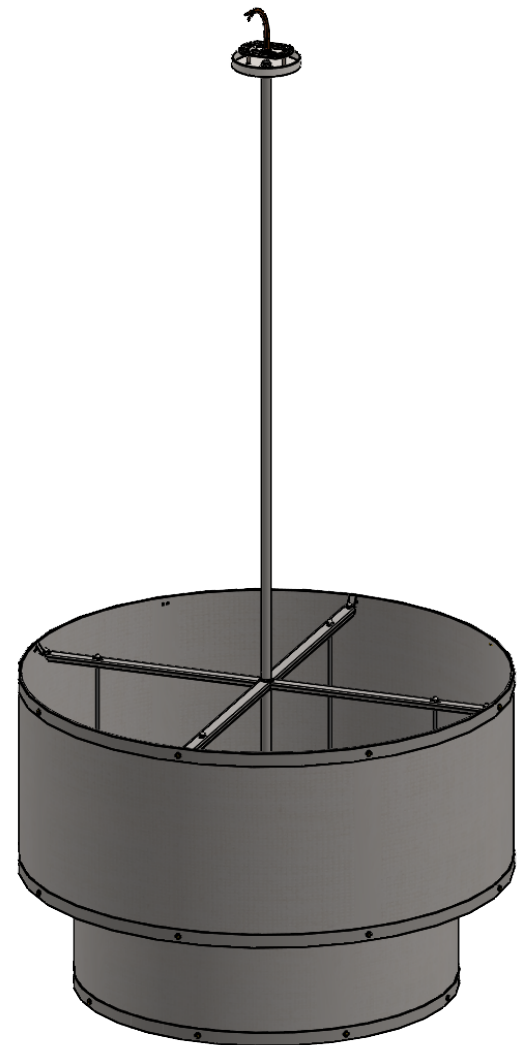



**CUSTOMER PROPOSAL / CUT SHEET**  
"A Commitment to Excellence in Lighting and Service"  
CALL OUR CUSTOMER SERVICE DEPARTMENT AT 1-800-222-4009  
MONDAY - FRIDAY 9:00a.m - 5:00p.m ET  
visit us on the web at [www.meyda.com](http://www.meyda.com)

REVISION:

**1. MOUNTING PLATE WITH STUDS**

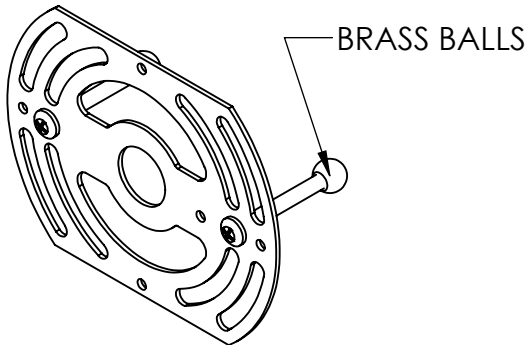

**2. CANOPY STEM**



**3. SMALLER FABRIC SHADE**

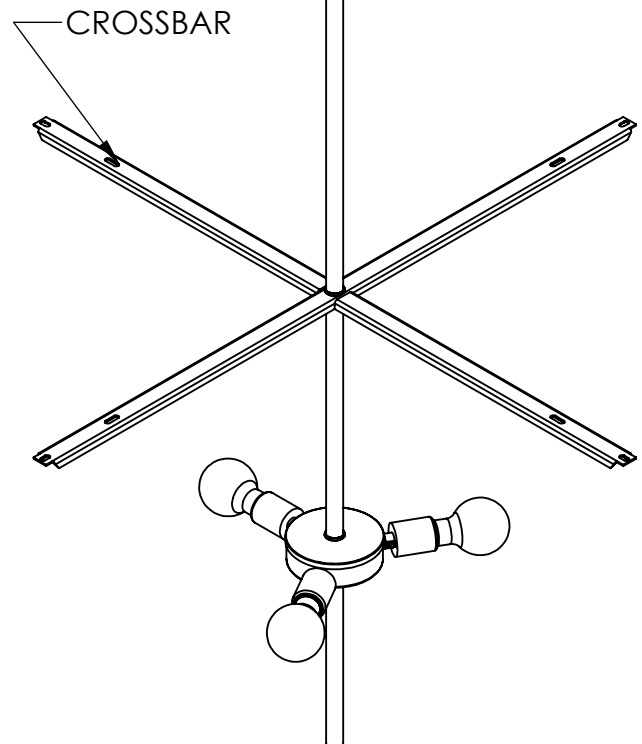
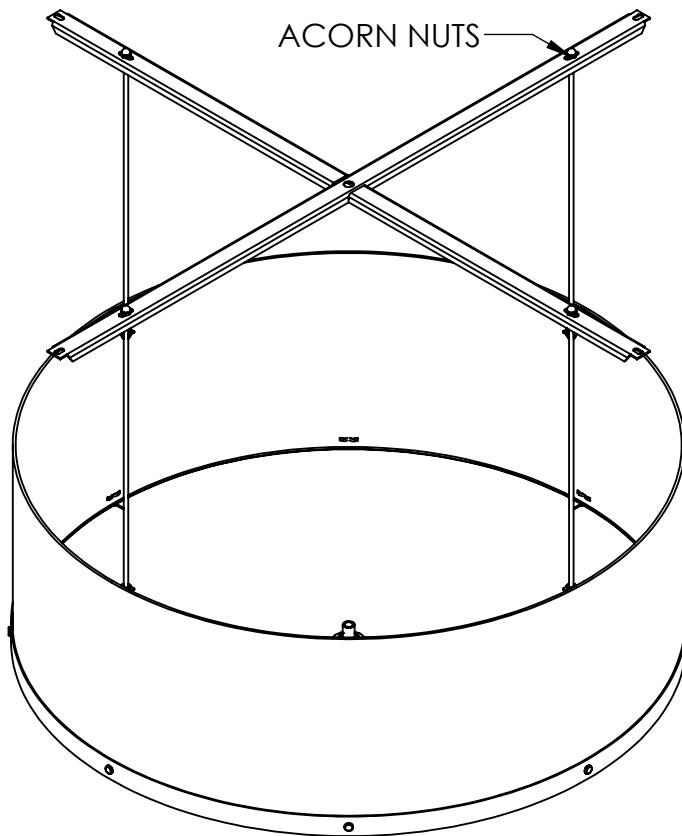

\*DIMENSIONS AND DETAILS ARE SUBJECT TO MODIFICATION DURING PRODUCTION  
© MEYDA TIFFANY INC © DESIGN COPYRIGHT, MEYDA TIFFANY, INC. ALL RIGHTS RESERVED, NO UNAUTHORIZED DUPLICATION

\*TRANSPARENT FINISHES WILL VARY DEPENDING ON THE MATERIAL TO WHICH IT IS APPLIED AND THE FABRICATION TECHNIQUE.



ID# 1-0040233309-8737(284772)	W/O# 1515274	BULB# 3	DATE:5/30/2025
CUST. DESIGN#	QTY: 1	TYPE: E26 A19	DRAWN BY:IF 1071
FIXTURE TYPE: PENDANT	WATTS:60	VOLTAGE:120	SCALE: 1:2
LENS COLOR:100374 WHITE ACRYLIC 2447(NOT FROSTED) \ -305150 (36"W X 15"H GRAY BUTCHER LINEN DRUM SHADE) \ -305151 (28"W X 10"H GRAY BUTCHER LINEN DRUM SHADE)	TOTAL AMPS: 1.5	APPROVAL:	
METAL FINISH:3SLRBLK SOLAR BLACK (106404) / 3WH GLOSS WHITE - STANDARD (200857)	LOCATION: DAMP	EST. WEIGHT:27 LBS	
MATERIAL:STEEL/ ACRYLIC/ FABRIC	NOTES:	SHEET: 2 OF 3	



**CUSTOMER PROPOSAL / CUT SHEET**  
**"A Commitment to Excellence in Lighting and Service"**  
CALL OUR CUSTOMER SERVICE DEPARTMENT AT 1-800-222-4009  
MONDAY - FRIDAY 9:00a.m - 5:00p.m ET  
visit us on the web at [www.meyda.com](http://www.meyda.com)

REVISION:

**4. LARGER FABRIC SHADE**

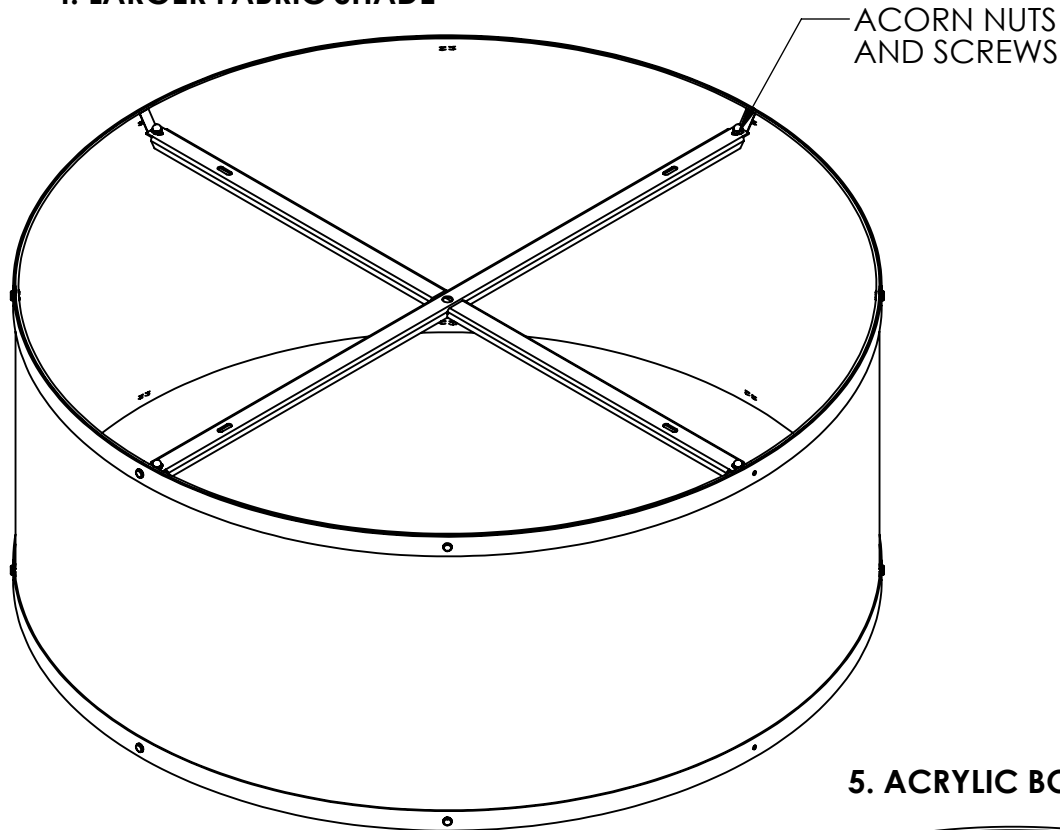

**5. ACRYLIC BOTTOM**

FINIAL AND ROUND CHECK RING

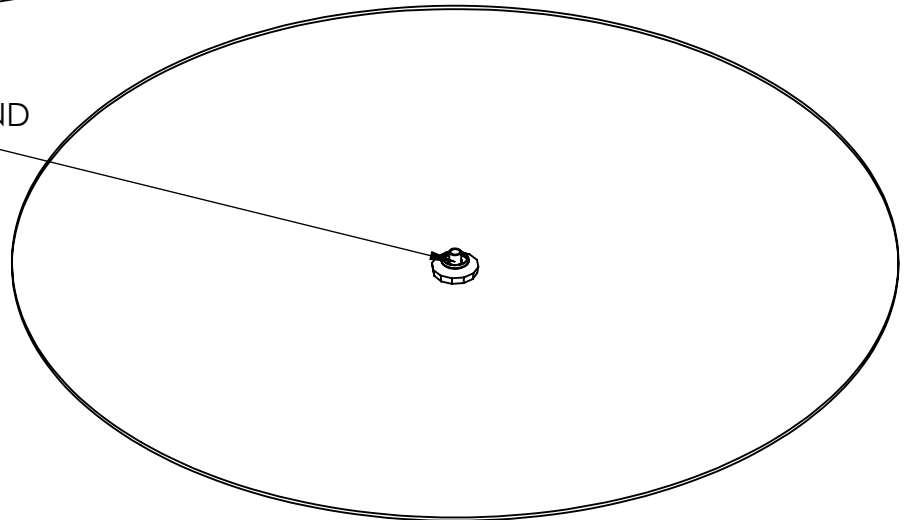

\*DIMENSIONS AND DETAILS ARE SUBJECT TO MODIFICATION DURING PRODUCTION  
© MEYDA TIFFANY INC © DESIGN COPYRIGHT, MEYDA TIFFANY, INC. ALL RIGHTS RESERVED, NO UNAUTHORIZED DUPLICATION



\*TRANSPARENT FINISHES WILL VARY DEPENDING ON THE MATERIAL TO WHICH IT IS APPLIED AND THE FABRICATION TECHNIQUE.

ID# 1-0040233309-8737(284772)	W/O# 1515274	BULB# 3	DATE:5/30/2025
CUST. DESIGN#	QTY: 1	TYPE: E26 A19	DRAWN BY:IF 1071
FIXTURE TYPE: PENDANT	WATTS:60	VOLTAGE:120	SCALE: 1:16
LENS COLOR:100374 WHITE ACRYLIC 2447(NOT FROSTED) \ -305150 (36"W X 15"H GRAY BUTCHER LINEN DRUM SHADE) \ -305151 (28"W X 10"H GRAY BUTCHER LINEN DRUM SHADE)	TOTAL AMPS: 1.5	APPROVAL:	
METAL FINISH:3SLRBLK SOLAR BLACK (106404) / 3WH GLOSS WHITE - STANDARD (200857)	LOCATION: DAMP	EST. WEIGHT:27 LBS	
MATERIAL:STEEL/ ACRYLIC/ FABRIC	NOTES:	SHEET: 3 OF 3	