

INSTALLATION INSTRUCTIONS

FOR ITEM 251349 (56"W Prime Dome Flushmount Chandel-Air)

Meyda
CUSTOM LIGHTING

CAUTION: FAILURE TO INSTALL THIS FIXTURE PROPERLY MAY RESULT IN SERIOUS PERSONAL INJURY OR DEATH AND PROPERTY DAMAGE. We recommend installation by a licensed electrician.

This product must be installed in accordance with applicable installation code(s), by a person familiar with the construction and operation of the product and the hazards involved.*

Caution: Do not exceed maximum wattage noted on fixture. Use only recommended bulbs with fixture.

FIXTURE COMPONENTS

1. CANOPY ASSEMBLY (CANOPY, MOUNTING SADDLE, COVER PLATE)
2. SCREW (QTY.-6)
3. CHANDEL-AIR BODY

Caution:

Fixture is OVERWEIGHT and not suitable for installation with standard Junction Box.

Be sure power is off at the main breaker box prior to installation.

Read all instructions in their entirety before beginning installation.

1. Carefully unpack all components and make certain that everything is on hand.
2. Remove Screws from Canopy Assembly to release the Cover Plate, save these for later.
3. Detach Mounting Saddle from the Chandel-Air Body.
4. Using Customer Supplied hardware, affix the Mounting Saddle and Canopy directly to the ceiling ensuring the connection is suitable for 200 lbs. and that electrical supply wires remain accessible.
5. Install 16X E26A19 LED and 4X E26MR16 HALOGEN bulbs (not included).
6. Lift Chandel-Air Body up to the ceiling and seat Steel Half Ball into the Mounting Saddle.
7. Following all local codes and procedures, make electrical wire connections from supply wires to fixture lead wires.
8. Reinstall the Cover Plates using the screws from before.
9. Power on and ENJOY!!!

CANOPY

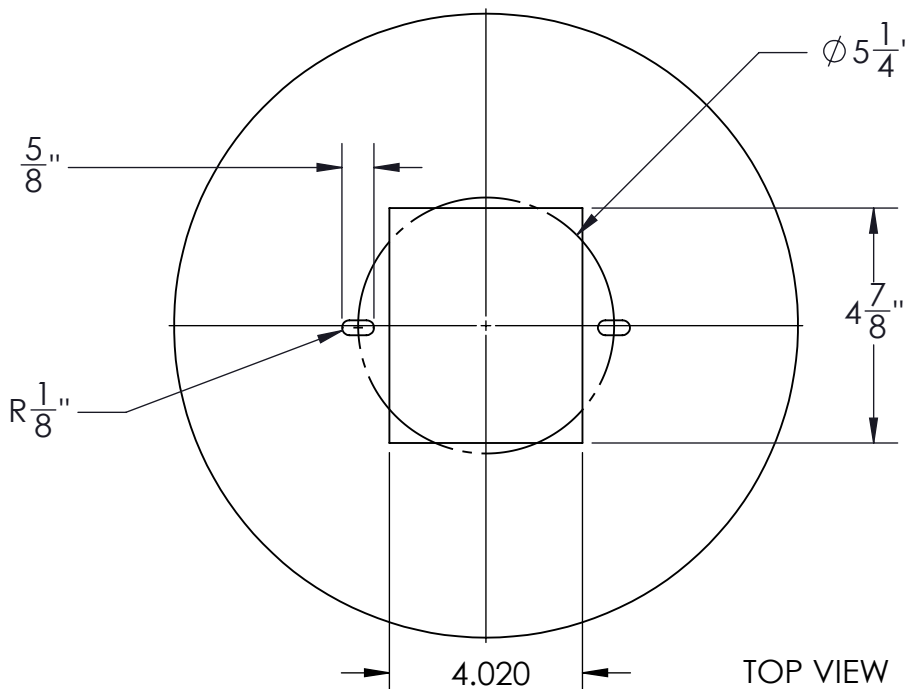

INSTALLATION INSTRUCTIONS

FOR ITEM 251349 (56"W Prime Dome Flushmount Chandel-Air)

Meyda
CUSTOM LIGHTING

CAUTION: FAILURE TO INSTALL THIS FIXTURE PROPERLY MAY RESULT IN SERIOUS PERSONAL INJURY OR DEATH AND PROPERTY DAMAGE. We recommend installation by a licensed electrician.

This product must be installed in accordance with applicable installation code(s), by a person familiar with the construction and operation of the product and the hazards involved.*

Caution: Do not exceed maximum wattage noted on fixture. Use only recommended bulbs with fixture.

