

INSTALLATION INSTRUCTIONS

FOR ITEM 251123

Meyda
CUSTOM LIGHTING

CAUTION: FAILURE TO INSTALL THIS FIXTURE PROPERLY MAY RESULT IN SERIOUS PERSONAL INJURY OR DEATH AND PROPERTY DAMAGE. We recommend installation by a licensed electrician.

This product must be installed in accordance with applicable installation code(s), by a person familiar with the construction and operation of the product and the hazards involved.*

Caution: Do not exceed maximum wattage noted on fixture. Use only recommended bulbs with fixture.

FIXTURE COMPONENTS

1. MOUNTING PLATE
2. CANOPY
3. LAMPING ASSEMBLY
4. GLASS SHADE

Caution:

Fixture is OVERWEIGHT and not suitable for installation with standard Junction Box.

Be sure power is off at the main breaker box prior to installation.

Read all instructions in their entirety before beginning installation.

1. Carefully unpack all components and make certain that everything is on hand.
2. Unscrew all of the Acorn and Hex Nuts from the Canopy to remove the Mounting Plate and the Lamping Assembly.
3. Using Customer Supplied Hardware, affix the Mounting Plate to the Ceiling ensuring the connection is suitable for a minimum of 75 lbs and that electrical supply wires remain accessible.
4. Reconnect the Canopy to the Mounting Plate using the appropriate Acorn and Hex Nuts from before.
5. Following all local codes and procedures make electrical wire connections from supply wires to fixture lead wires and reconnect the Lamping Assembly to the Canopy with the remaining Acorn and Hex Nuts.
6. Attach provided Half Links to each Loop on the Canopy.
7. Install 8x 60W E26 A19 Bulbs (not included) into sockets.
8. Lift the Shade up and secure to the Canopy by Connecting the Loops to the Half Links and hand tightening them shut.
9. Power on and ENJOY!!!

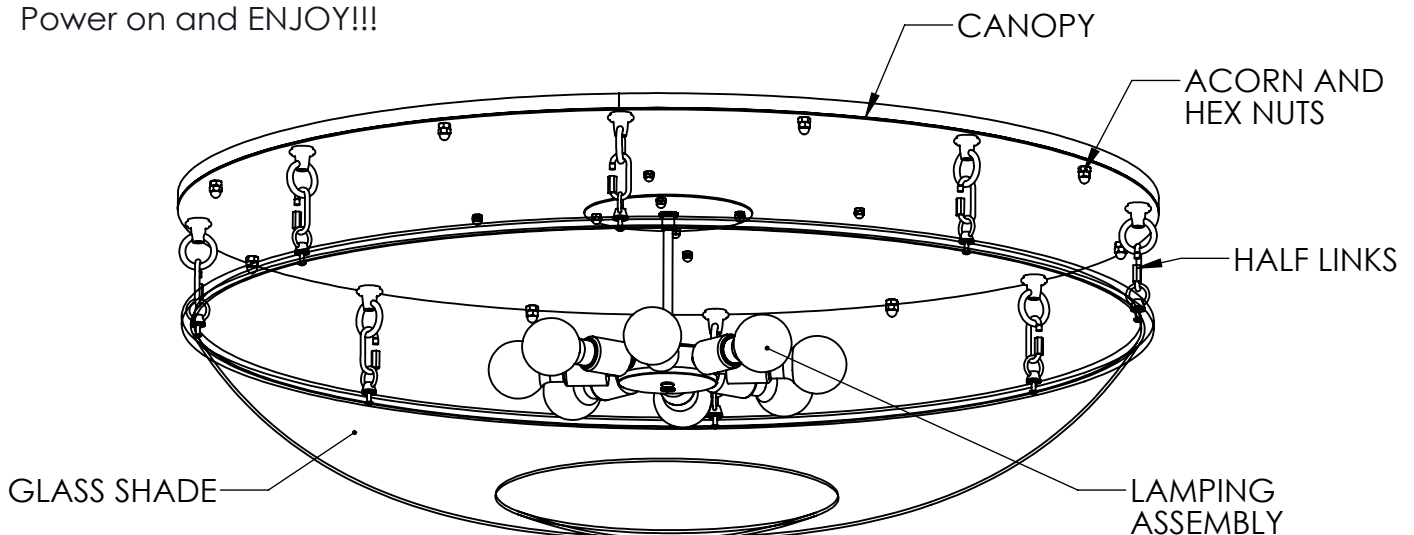



CUSTOMER PROPOSAL / CUT SHEET
"A Commitment to Excellence in Lighting and Service"
CALL OUR CUSTOMER SERVICE DEPARTMENT AT 1-800-222-4009
MONDAY - FRIDAY 9:00a.m - 5:00p.m ET
visit us on the web at www.meyda.com

REVISION:

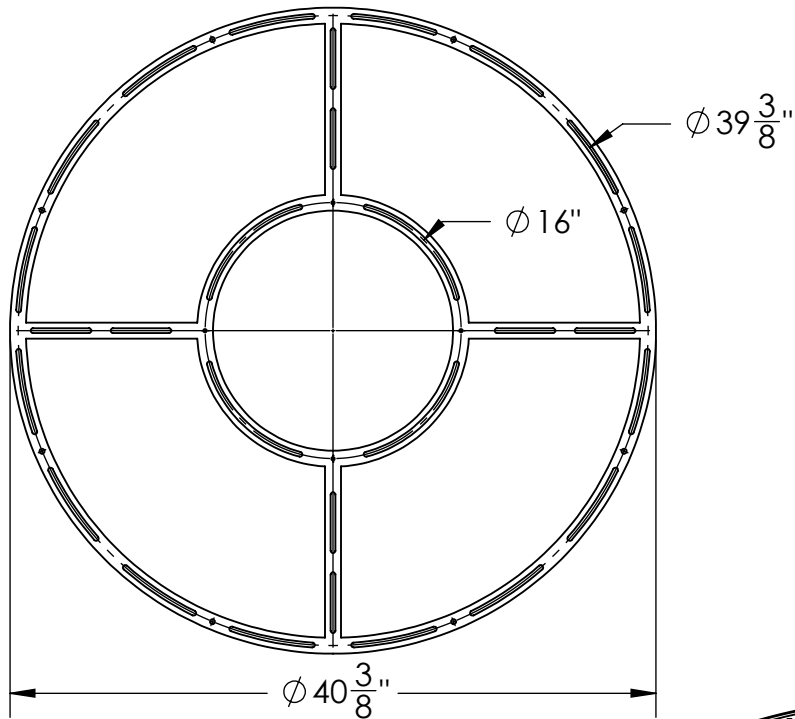

MOUNTING PLATE
DIMENSIONS

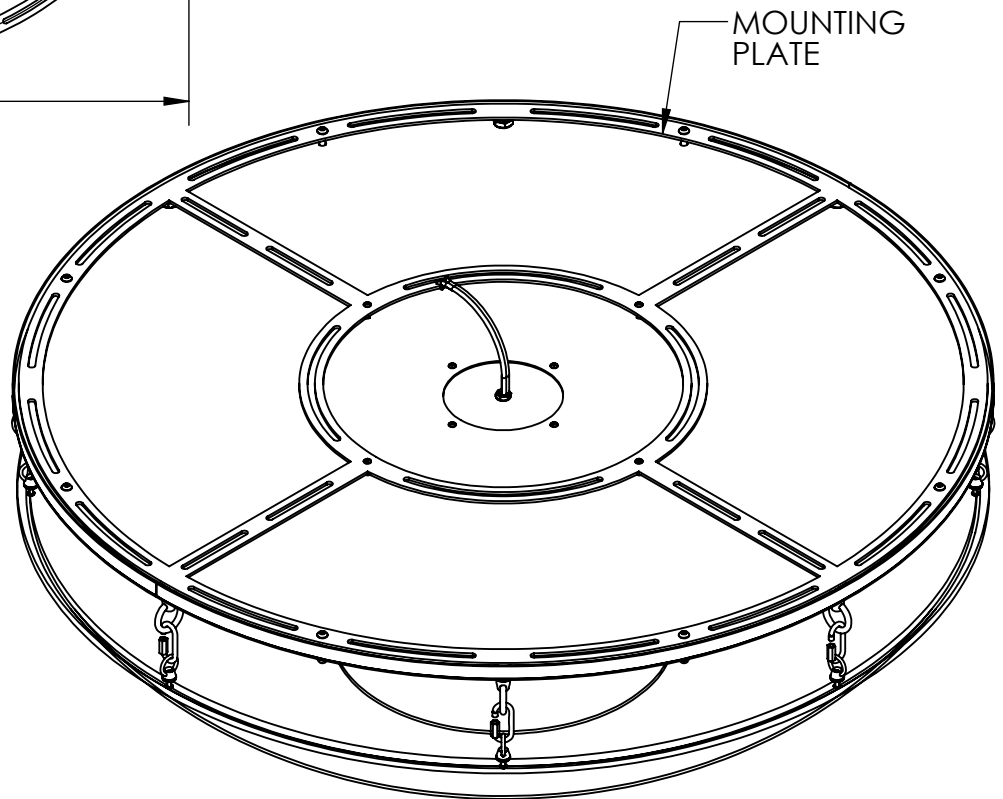

*DIMENSIONS AND DETAILS ARE SUBJECT TO MODIFICATION DURING PRODUCTION
© MEYDA TIFFANY INC © DESIGN COPYRIGHT, MEYDA TIFFANY, INC. ALL RIGHTS RESERVED, NO UNAUTHORIZED DUPLICATION



*TRANSPARENT FINISHES WILL VARY DEPENDING ON THE MATERIAL TO WHICH IT IS APPLIED AND THE FABRICATION TECHNIQUE.

ID# S17353-1500 & SG699-40-3(251123)	W/O# 1522348	BULB# 8	DATE:1/30/2026
CUST. DESIGN# JSID/BLOOM / PRAYER ROOM	QTY: 2	TYPE: E26 A19	DRAWN BY:IF1071
FIXTURE TYPE: FLUSH MOUNT	WATTS:60	VOLTAGE:120	SCALE: 1:32
LENS COLOR:SG699-40-3 (40" FLEUR-DE LIS DOME, JP VA XAG BLUE)	TOTAL AMPS:4	APPROVAL:	
METAL FINISH:3ORBBRZ OIL RUBBED BRONZE (106397)	LOCATION:DAMP	EST. WEIGHT:56.75 LBS	
MATERIAL:STEEL/ GLASS	NOTES:	SHEET: 2 OF 2	